

Perfil 02  
ESC 1 : 300

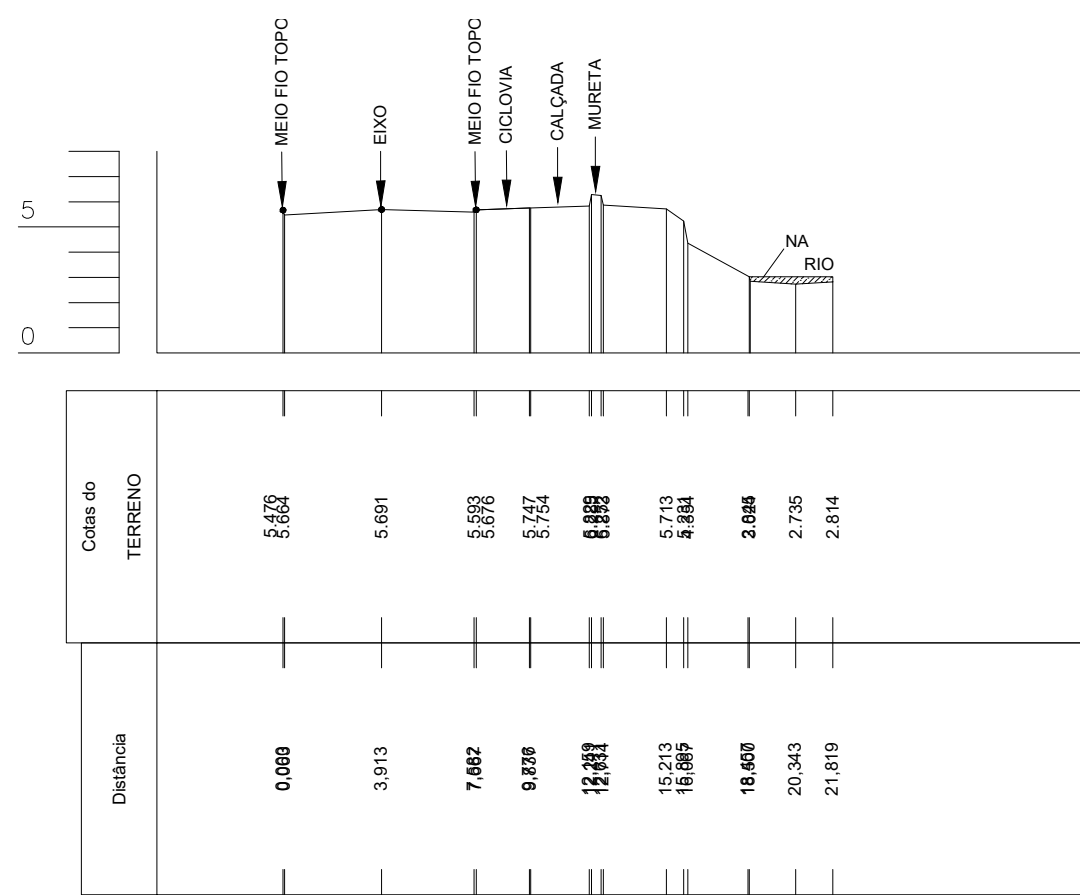

Perfil 03  
ESC 1 : 300

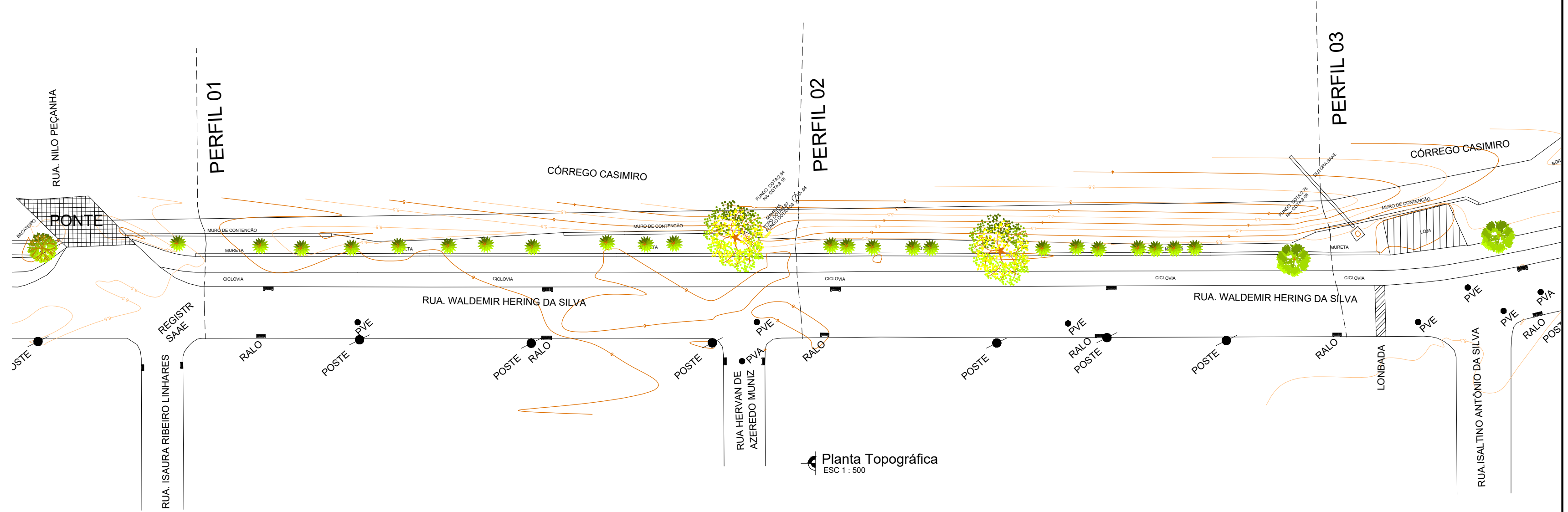

Planta Topográfica  
ESC 1 : 500

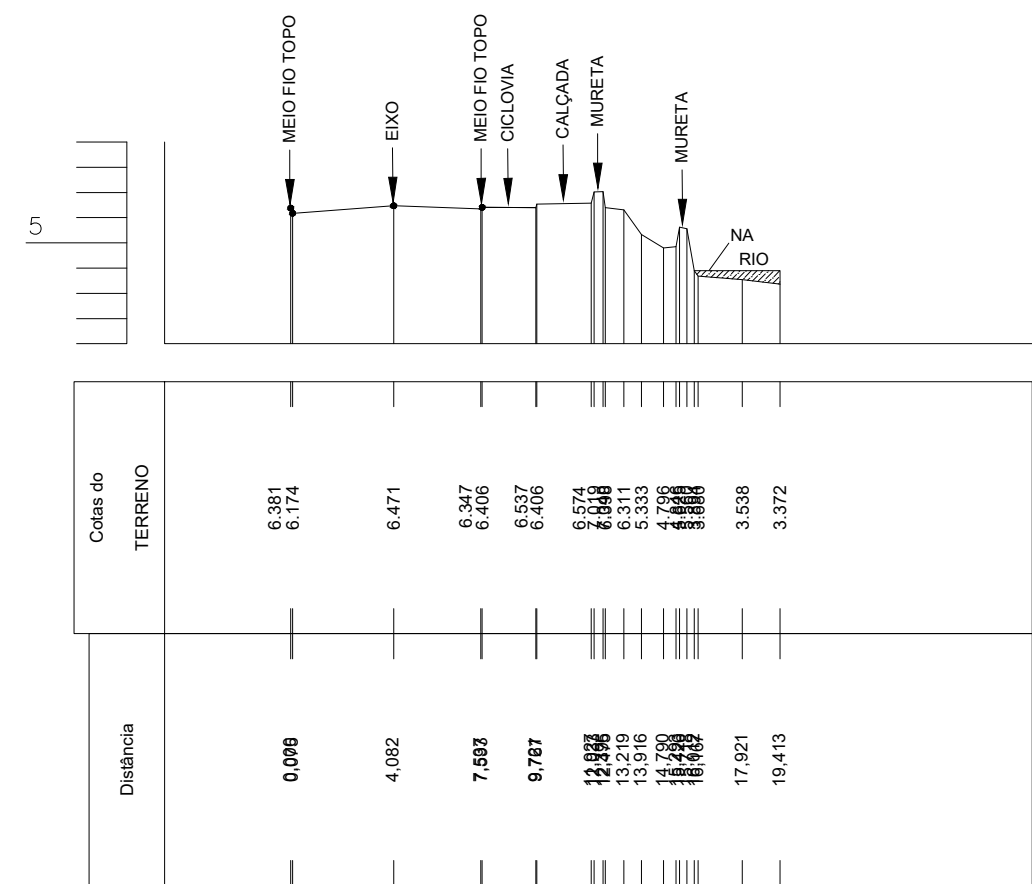

Perfil 01  
ESC 1 : 300

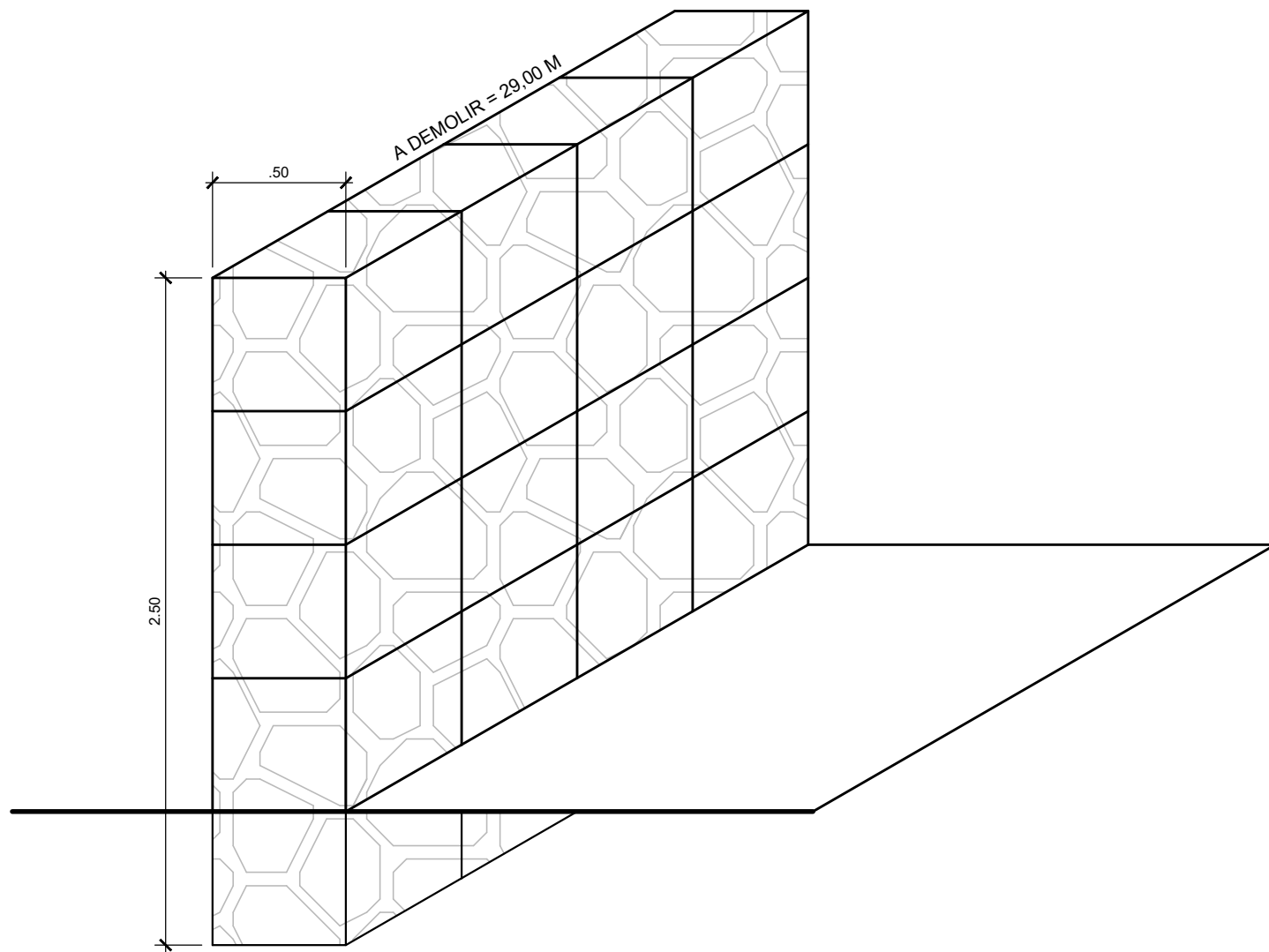

Isometria  
ESC 1 : 20  
MURO DE PEDRA A DEMOLIR

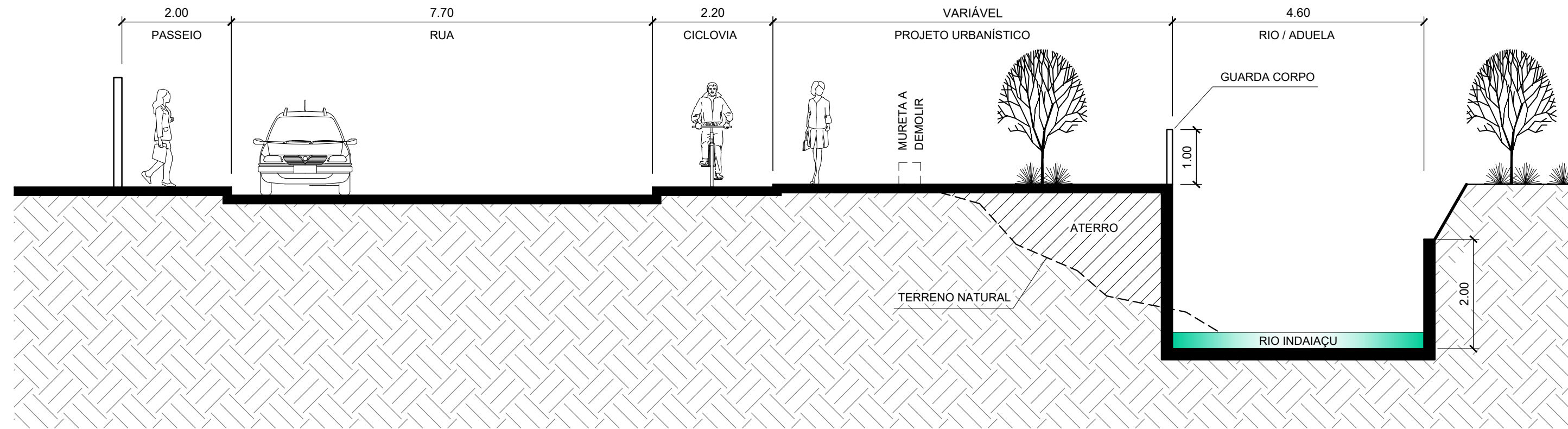

Corte A - A  
ESC 1 : 75

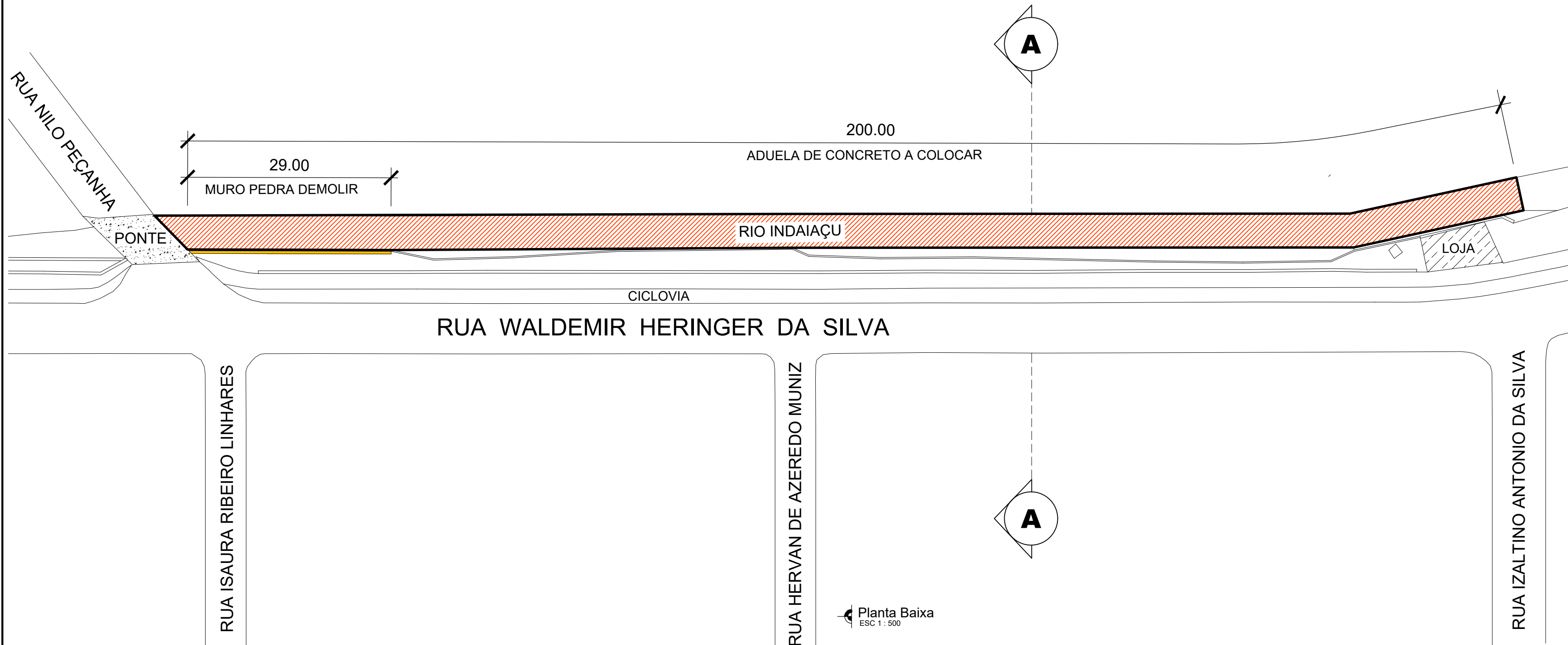

Planta Baixa  
ESC 1 : 500

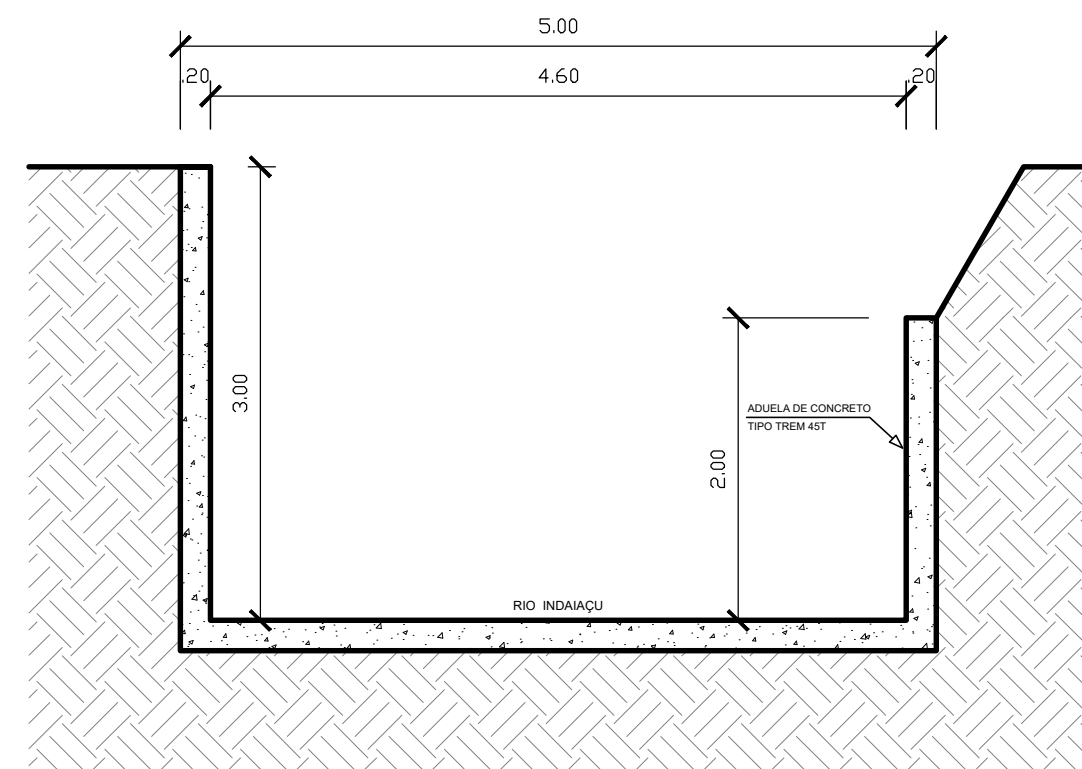

Corte A - A  
ESC 1 : 50  
ADUELA DE CONCRETO A CONSTRUIR

\*\*\* LEGENDA \*\*\*

- MURO DE PEDRA A DEMOLIR
- ADUELA DE CONCRETO A CONSTRUIR

LEGENDA CONSTRUIR / INSTALAR  
ADUELA DE CONCRETO 200,00 M  
MURO DE PEDRA A DEMOLIR 29 M



PREFEITURA DE CASIMIRO DE ABREU

PROJETO PARA CONSTRUÇÃO DE ADUELAS  
DE CONCRETO NO RIO INDIAIÇU, SITO NA  
RUA WALDEMIR HERINGER DA SILVA,  
CASIMIRO DE ABREU.....RJ

FOLHA:

01/01

INFORMAÇÕES:

ESCALA INDICADA  
DATA ABRIL 2024  
DESENHISTA WEZELIN FARIA

Gestor

Ass. Prof.

CARIMBO